

Varme Plus Installation Structure depending on cover material

◆ Laminate Floor (Click type)

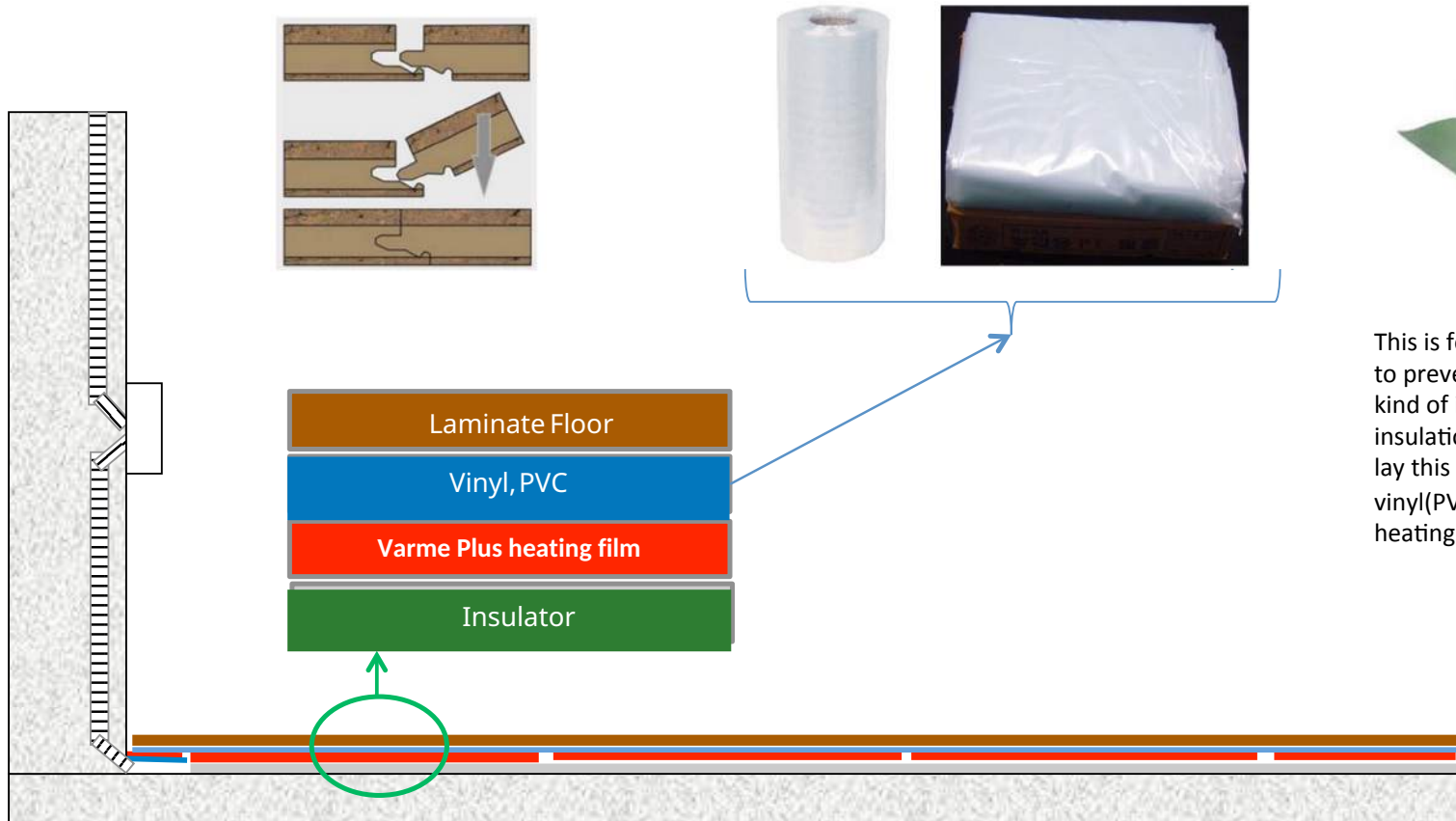

This is form which lay under laminate floor to prevent humidity and impact, but it is kind of insulator. There is already our insulator under film, so you don't need to lay this form. I recommend to lay the vinyl(PVC) between laminate floor and heating film to prevent water damage.



◆ Carpet tile, Vinyl flooring or Vinyl tile (Glue type)

* Protection Layer

- Any-materials are OK

It must be

Easy to install, not much shrink or expand by heating, able to use glue.

- I recommend plywood (thickness : 2mm~)

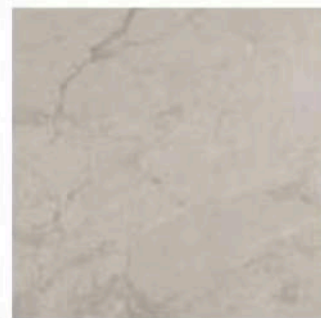
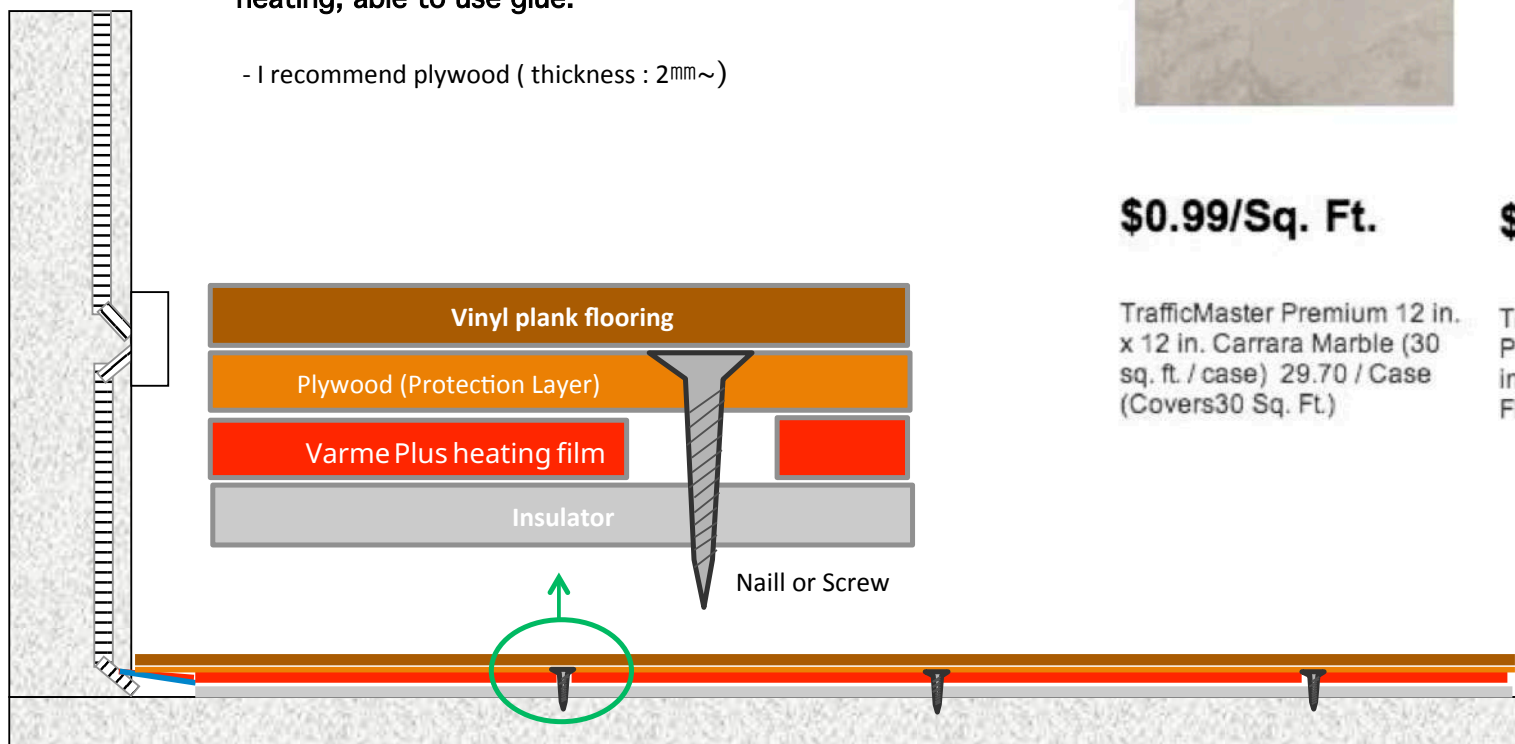

\$0.99/Sq. Ft.

TrafficMaster Premium 12 in. x 12 in. Carrara Marble (30 sq. ft. / case) 29.70 / Case (Covers 30 Sq. Ft.)

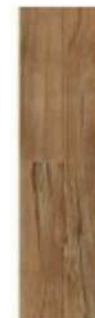

\$2.39/Sq. Ft.

TrafficMaster Allure Plus Sahara Wood 5 in. x 36 in. Resilient Vinyl Plank Flooring (22.5 Sq. ft./Case)



◆ Carpet or Vinyl sheet (which can damage heating film with impact)

* Protection Layer

- Any materials are OK

It must be

Easy to install, not much shrink or expand by heating.

- We use PE board.

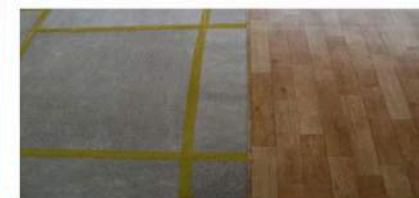
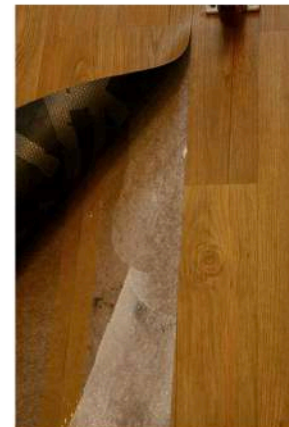
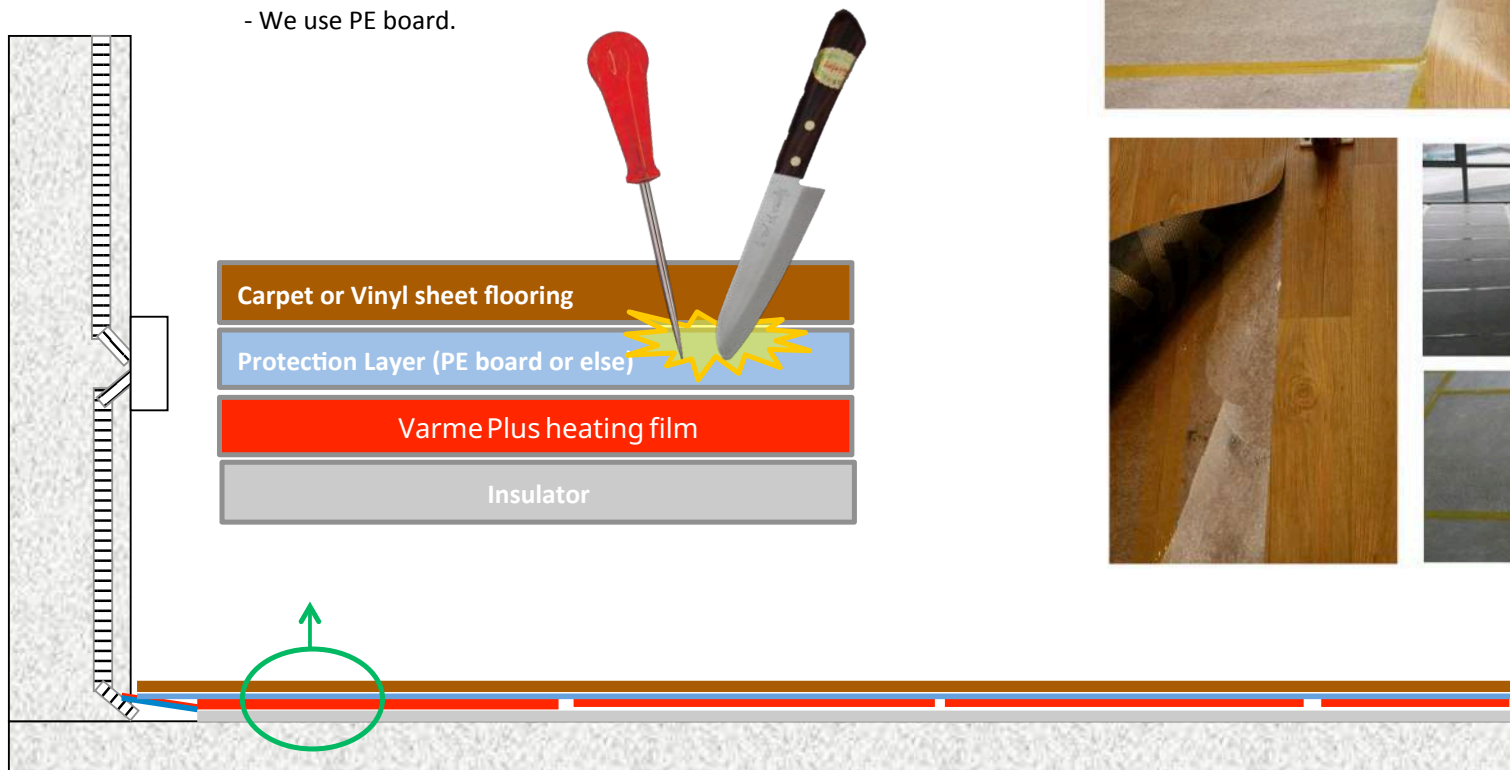

◆ Ceramic, Marble, or Tile (Plastering type)

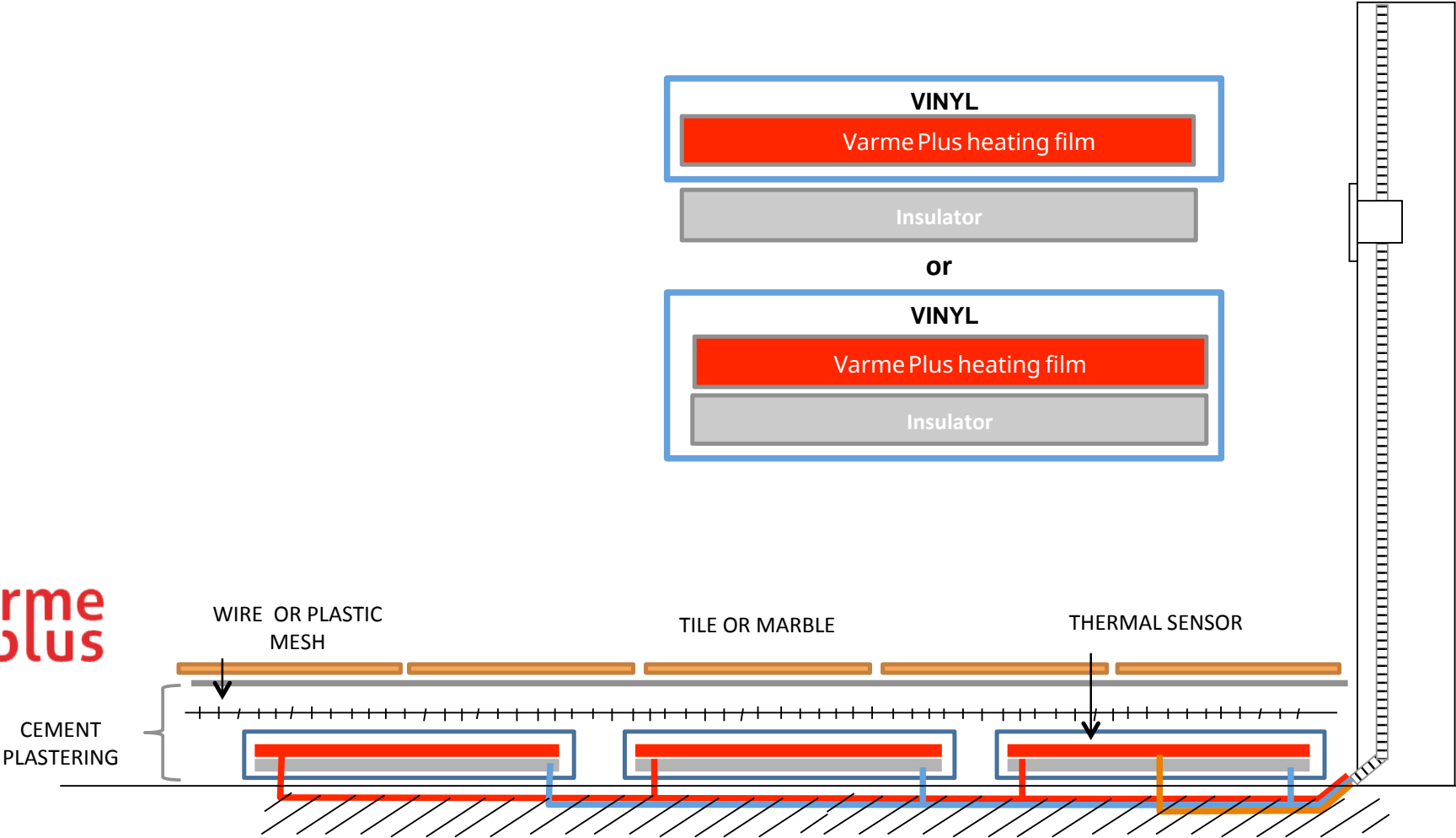

◆ Wall (Dry Sauna or other uses)

Installing on the wall is one of the most difficult types of installation. You need to discuss with the person who will do the work for you. Of course, there are many methods to install with covering.

Case 1.

Step 1. Installing Hi Heat

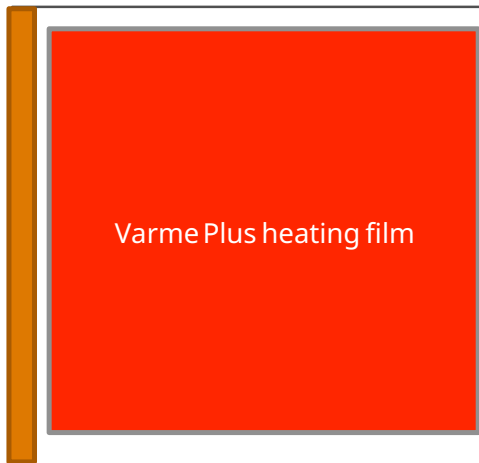

Step 2. Installing Protection Board

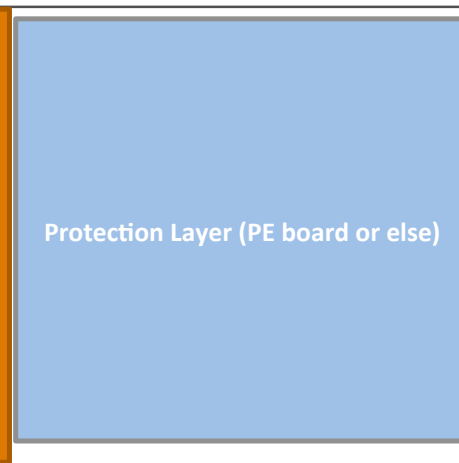

Step 3. Covering

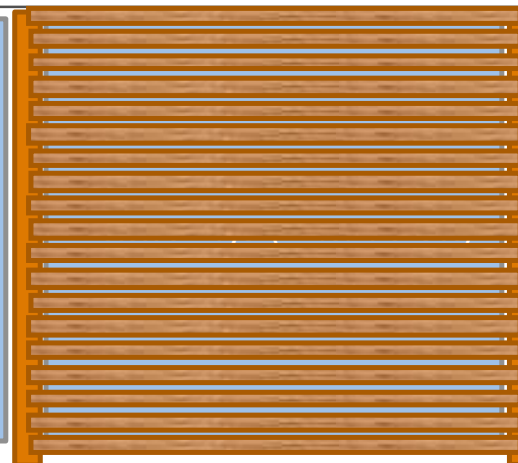

Case 2.

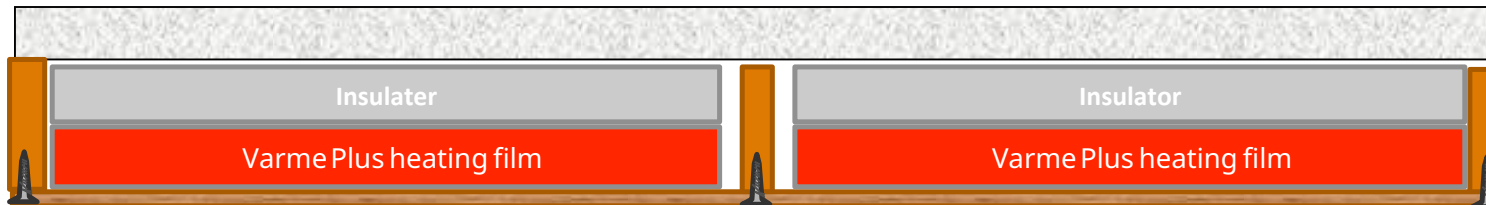

Case 3.

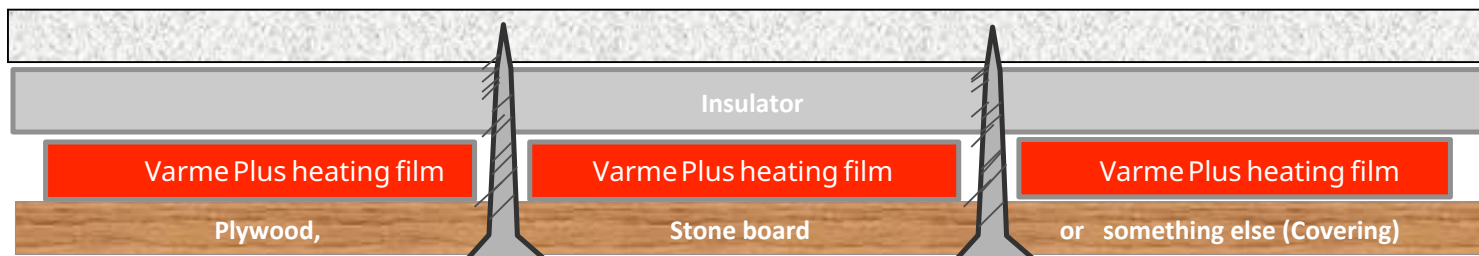



Covering : Solid Hardwood

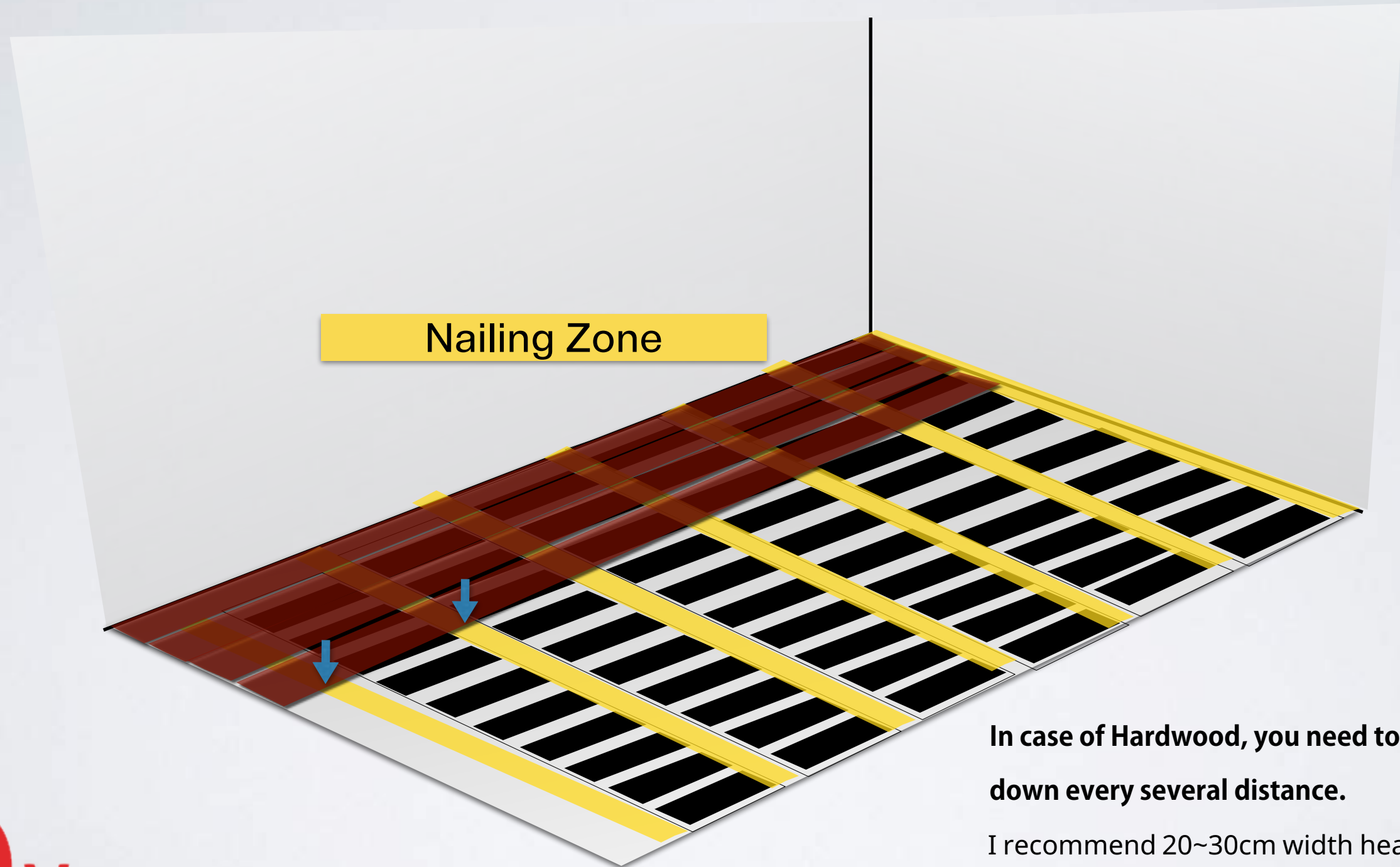

In case of Hardwood, you need to nail down every several distance.

I recommend 20~30cm width heating films and nail between sheets (Nail Zone)